

**AMBIENT AIR PUMP
INTAKE EXTENSIONS
O. M. 21847**

MC FILE NUMBER: 2066-0998
DATE OF ISSUE: 09/98
REVISION: A, 04/10

⚠ WARNING

Do not proceed with these instructions* until you have READ the orange cover of this MANUAL and YOU UNDERSTAND its contents.

These WARNINGS are included for the health and safety of the operator and those in the immediate vicinity.

***If you are using a Clemco Distributor Maintenance and Part Guide, refer to the orange warnings insert preceding the Index before continuing with the enclosed instructions.**

Electronic files include a Preface containing the same important information as the orange cover.

© 2010 CLEMCO INDUSTRIES CORP.
One Cable Car Dr.
Washington, MO 63090
Phone (636) 239-4300
Fax (800) 726-7559
Email: info@clemcoindustries.com
www.clemcoindustries.com



1.0 INTRODUCTION

1.1 These instructions explain the installation of all intake extensions used on a CAP-1 Ambient Air Pump. This material does not contain important warnings and safety information regarding the hazards associated with the use of air pumps and supplied-air respirators. Read the instructions supplied with the respirator and air pump, to ensure Grade "D" quality respirable air is supplied to the respirator.

⚠ WARNING

Air supplied to the respirator must be at least Grade "D" quality respirable air, containing no less than 19.5 volume-percent of oxygen. Breathing air requirements are described in Compressed Gas Association, G-7.1., Commodity Specification For Air, published by Compressed Gas Association Inc., Arlington, VA. The pump filters are particulate filters. They do not remove carbon monoxide or other toxic gases. Air supplied to the pump intake must be at least Grade "D" quality. If air quality is unknown, consult a safety professional and/or industrial hygienist. Poor quality air will cause serious respiratory injury or death to the user.

Extensions are required when the intake of the ambient air pump cannot be placed in an area where clean, respirable air is guaranteed. An intake 36-in. intake stack or a 50 ft. air intake hose and up to five additional 50 ft. extension hoses (for a total maximum length of 300 ft.) may be attached to the pump inlet to draw air from an area where clean, respirable air is ensured at all times.

- The area must be free of harmful vapors and gases, including carbon monoxide, which is found in engine exhaust, and in any form of combustion.
- The area must not be near any exhaust system outlet, ventilation flue, vehicle traffic, or any other fumes.
- The area must be free of airborne contaminants generated from the process requiring the use of the respirator. This would include silica dust, generated from sandblasting, and dust from lead or other heavy metals, produced from the removal or application of coatings containing toxic elements.
- Refer to the air pump and respirator manuals for additional warnings and safety information regarding the use of air pumps and supplied-air respirators.

2.0 CONNECTING THE ELEVATED INTAKE STACK

Ref. Figure 1

2.1 Remove the inlet filter assembly from the pump end plate.

2.2 If the close nipple remains in the end plate, thread the coupling end of the stack pipe extension onto the nipple, and connect the inlet filter to the other end. If the close nipple remains with the filter, screw the male threaded end of the stack pipe extension into the end plate, and connect the filter to the coupling end.

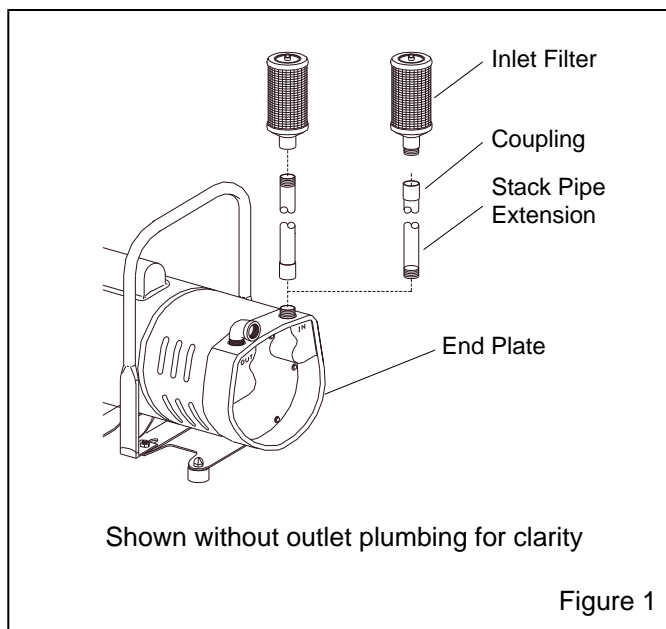

3.0 CONNECTING INTAKE HOSE AND HOSE EXTENSION, Ref. Figure 2

NOTE: More fittings are provided than are needed to make the connections. Discard unused fittings.

3.1 Remove the inlet filter assembly from the pump end plate.

3.2 Remove a connector assembly from either end of the intake hose. Take care not to misplace the beveled sealing ring.

3.3 If the close nipple remained with the inlet filter, screw the 3/8" NPT hex nipple and 3/4" x 3/8" bushing into the connector assembly, and securely attach the assembly to the pump end plate. If the nipple remained in the end plate, attach the bushing and connector assembly to the nipple.

3.4 Verify that the beveled sealing ring is in place, and attach the intake hose to the connector attached to the pump.

3.5 Using the fittings provided, connect the inlet filter to the other end of the intake hose. If more than 50 feet of hose is needed, attach an extension hose to the end

of the intake hose, using the union and rubber gaskets provided, and then attach the inlet filter to the end of the extension. The maximum overall length of the inlet hose and extension is 300 feet.

3.6 Route the filter end of the hose to a location where clean respirable Grade "D" air is ensured.

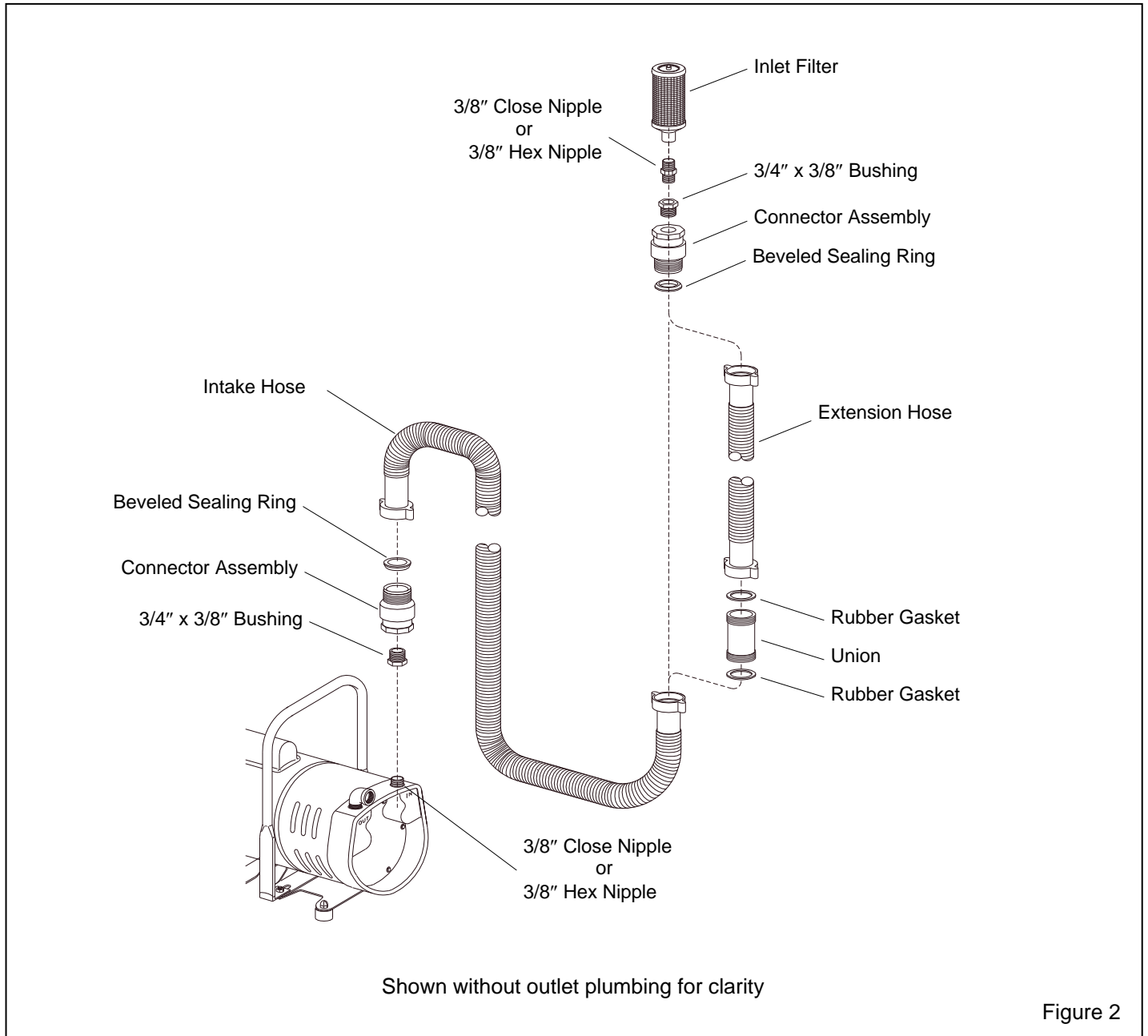

Figure 2