

**1.0 Remove Handle Lever, Figure 1**

1.1 Remove the lock nut from the shoulder screw. Before removing the screw, note the positions of the spacers and spring as shown in Figure 1. The bent end of the spring is against the handle lever and facing up. The straight end is against the body and facing down. The spring and spacers must be placed correctly when reinstalling the handle per Section 5.0.

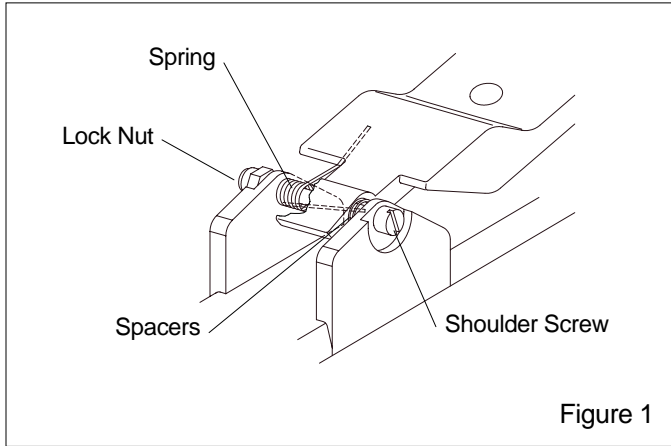

Figure 1

**2.0 Remove Old Switch, Figure 2**

2.1 Remove screws holding the switch and cord clamps. Save one cord clamp and all four clamp screws for reuse. Discard switch and switch hold-down screws.

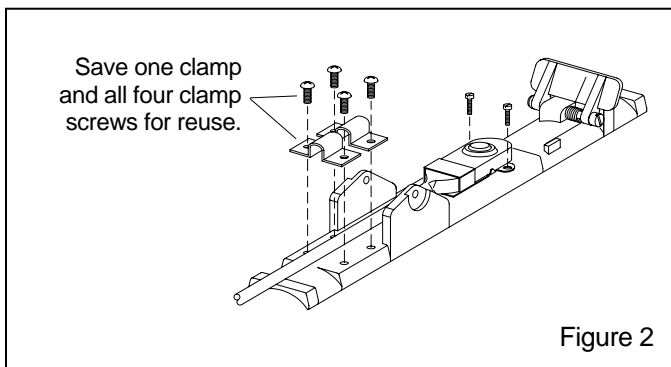

Figure 2

**3.0 Replace Connector**

Follow instructions in Section 3.1 for Lo-Profile connector, or Section 3.2 for Twist-Lock connector.

**3.1 Lo-Profile Connector: Ref. Figure 3**

3.1.1 Remove the compression nut, thrust washer, and gasket from the connector shell.

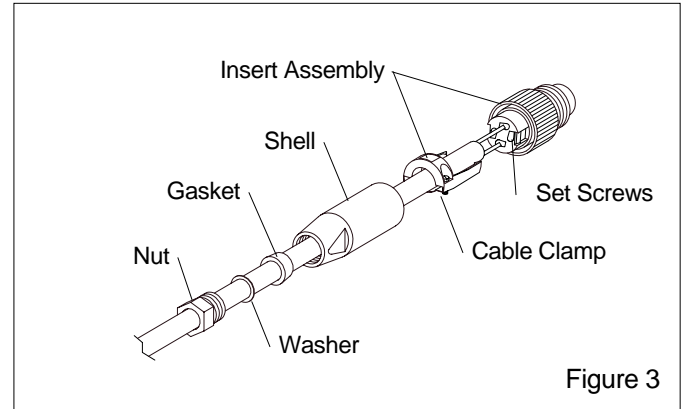

Figure 3

3.1.2 Unscrew the shell from the coupling insert assembly.

3.1.3 Loosen the cable clamp and set screws holding the cord, and remove the cord from the assembly.

3.1.4 Attach the connector on a new switch and cord assembly using Terminals No. 1 and 3.

3.1.5 Reassemble the connector in reverse order, making sure the cable clamp securely grips the cord, and when the connector is assembled make sure the compression nut, thrust washer and gasket seals tightly around the cord.

3.1.6 Continue at Section 4.0.

**3.2 Twist-Lock Connector**

3.2.1 Loosen the screws clamping the cord

3.2.2 Loosen the screws the front to the back of the connector.

**3.2.3** Pull the shell off the plug, and remove the two leads from the screw terminals.

**3.2.4** Attach a new switch and cord assembly, either lead can go on either terminal. Reassemble the connector in reverse order.

**3.2.5** Continue at Section 4.0.

---

**⚠ WARNING**

---

**Before using the control handle, refer to the RLX Owner's Manual, Stock Number 10574 for complete operating instructions.**

---

#### **4.0 Attach New Switch, Ref. Figure 4**

**4.1** Use two of the clamp screws to attach the switch to the forward clamp-screw holes as shown in Figure 4.

**4.2** Place a cord clamp over the cord, and use two screws to attach it to the rearward screw holes.

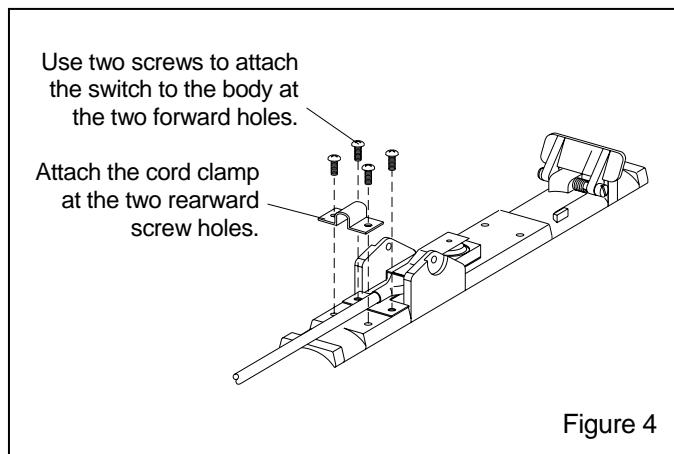

#### **5.0 Attach Handle Lever**

**5.1** Reassemble the handle lever, making sure the spring and spacers are placed as shown in Figure 1. Use a new return spring if the current spring does not raise the handle lever to the full up position.

**5.2** Make sure the handle lever moves freely, raises to full up position, and does not engage the switch unless the lever lock is pulled down.

**5.3** Before putting the control handle in service, test the switch by pressing and releasing the lever. The switch should click each time the handle is pressed (engaging the switch) and released (disengaging the switch).